

TECHNI-SPRING - STEEL BASE:



FEATURES:

- Active Base - Spring Feature is Derived from Base
- Powder Coated Steel Base with Leaf Spring
- Available for Use With 6 &, 8" Length Boards
- 2 Hole Drill Pattern 12" on center
- Refer to Board Chart on Pg. 7
- Refer to Available Base Colors on Pg. 7

Part # TSB (Techni-Spring Steel Base)
 Part # TSS6 (6' Spring Assembly) **OR** Part # TSS8 (8' Spring Assembly)

NOTE: MUST ORDER 3 PARTS FOR A COMPLETE TECHNI-SPRING BASE AND BOARD COMBINATION.

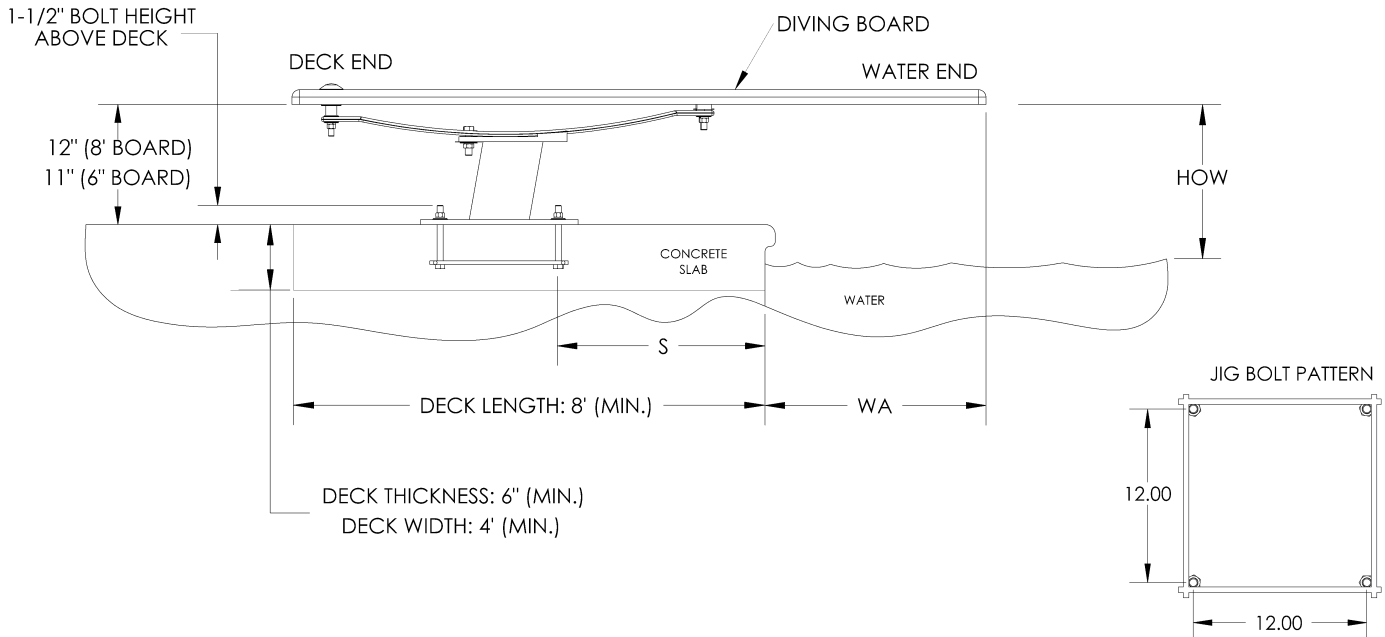

| IMPORTANT: THESE DIMENSIONS ARE ACCURATE ONLY FOR VERTICAL POOL WALLS, TYPICALLY GUNITE CONSTRUCTION , WITH LESS THAN A 3' RADIUS TO THE POOL FLOOR. DUE TO THE VARYING SIZES OF OTHER POOLS, TYPICALLY VINYL LINER CONSTRUCTION , PLEASE CONTACT CUSTOMER SERVICE FOR PROPER JIG PLACEMENT. 1-800-737-5386 | TECHNI-SPRING PART # (STEEL) | NOMINAL BOARD LENGTH | ANSI/NSPI-5 POOL TYPE | DISTANCE FROM WATER'S EDGE TO FORWARD JIG BOLT (S) | DISTANCE FROM END OF BOARD TO FORWARD JIG BOLT | MIN. OVERHANG PLUS OR MINUS 3" (WA) | MAX HEIGHT OF BOARD ABOVE WATER (HOW) | |
|--|------------------------------|----------------------|-----------------------|--|--|-------------------------------------|---------------------------------------|--|
| | TSB/TSS6 | 6' | I | 31.5" | 49.5" | 18" | 20" | |
| | TSB/TSS6 | 6' | II | 31.5" | 49.5" | 18" | 20" | |
| | TSB/TSS6 | 6' | III | 25.5" | 49.5" | 24" | 26" | |
| | TSB/TSS6 | 6' | IV | 19.5" | 49.5" | 30" | 30" | |
| | TSB/TSS6 | 6' | V | 13.5" | 49.5" | 36" | 40" | |
| | TSB/TSS8 | 8' | I | Cannot put 8' jump board on type I pool | | | | |
| | TSB/TSS8 | 8' | II | Cannot put 8' jump board on type II pool | | | | |
| | TSB/TSS8 | 8' | III | 44.25" | 68.25" | 24" | 26" | |
| | TSB/TSS8 | 8' | IV | 38.25" | 68.25" | 30" | 30" | |
| TSB/TSS8 | 8' | V | 32.25" | 68.25" | 36" | 40" | | |

TECHNI-SPRING - STEEL BASE (TSB & TSS6):

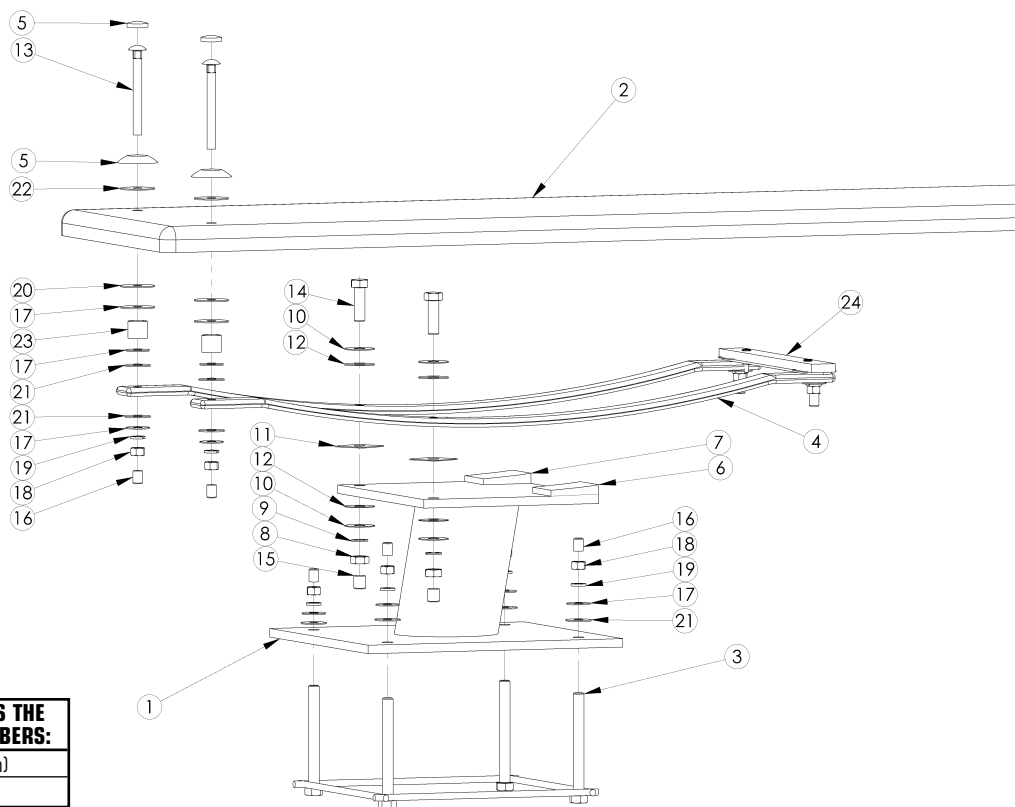

DRAWING REPRESENTS THE FOLLOWING PART NUMBERS:
 TSB & TSS6 (shown)
 TSB & TSS8

| ITEM # | COMPONENT | DESCRIPTION | KITS - QTY. COUNTS | | | | |
|--------|-----------------|--|--------------------|------|-------|------|------|
| | | | N/A | TB-M | TS-BK | TS-M | TSS6 |
| 1 | TS-B | Techni-Spring Steel Base | 1 | | | | |
| 2 | TB6WW | 6' Techni-Beam White w/White Top Tread & Hdw Kit | 1 | | | | |
| 3 | TS-EDGE-J | Techni-Spring Steel Base Mounting Jig | 1 | | | | |
| 4 | TSS6 | Techni-Spring Assembly & Mounting Hardware | | | | | 1 |
| 5 | H-WHT WAS/CAP | I.F. White Washer Cap | | 2 | | | |
| 6 | H-RIGHT PLUG | Right Base Nylon Plug | 1 | | | | |
| 7 | H-LEFT PLUG | Left Base Nylon Plug | 1 | | | | |
| 8 | H-SS 5/8 H NUT | 5/8-11 Hex Finish Nut S.S. | | | | 2 | |
| 9 | H-SS 5/8 LOC WA | 5/8 Split Lock Washer S.S. | | | | 2 | |
| 10 | H-SS 5/8 F WASH | 5/8" USS Flat Washer S.S. | | | | 4 | |
| 11 | H-5/8 SQ WASH | 5/8 x 2" Square Nylon Washer | | | | 2 | |
| 12 | H-5/8 RD WASH | 5/8 x 1-3/4" Round Nylon Washer | | | | 4 | |
| 13 | H-SS 5 C BOLT | 1/2-13 x5 Carriage Bolt S.S. | | 2 | | | |
| 14 | H-SS 5/8 HEX HD | 5/8-11 x 2 Hex C/S GR5 S.S. | | | | 2 | |
| 15 | H-1x1-1/2 W CAP | 1" I.D. x 1-1/2" Long White UV | | | | 2 | |
| 16 | H-1-1/2 WHT CAP | .750 x 1-1/2 White UV Nut Cap | | 2 | 4 | | |
| 17 | H-SS 1/2 F WASH | 1/2 USS Flat Washer S.S. | | 2 | 4 | 4 | |
| 18 | H-SS 1/2 H NUT | 1/2"- 13 Hex Finish Nut S.S. | | 2 | 4 | | |
| 19 | H-SS 1/2 LOC WA | 1/2 Lock Washer S.S. | | 2 | 4 | | |
| 20 | H-1/2 RED WASH | 1/2 x 2" Red Rubber Washer | | 2 | | | |
| 21 | H-1/2 NYLON WAS | 1/2" Flat Washer Nylon | | | 4 | 4 | |
| 22 | H-1/2 BLK WASH | 1/2 x 2" Black Rubber Washer | | 2 | | | |
| 23 | H-SS 1 SPACER | 1" Spacer S.S. | | | | 2 | |
| 24 | TS-FC | Techni-Spring Rubber Fulcrum Pad | 1 | | | | |

NOTES:

TB6WW diving board shown in exploded view for illustration purposes. Must be purchased separately. Other diving board options available.