

T7 DIVING SYSTEM (T7 DB-GR, T7 BASE-GR, T7 SPRING-GR):

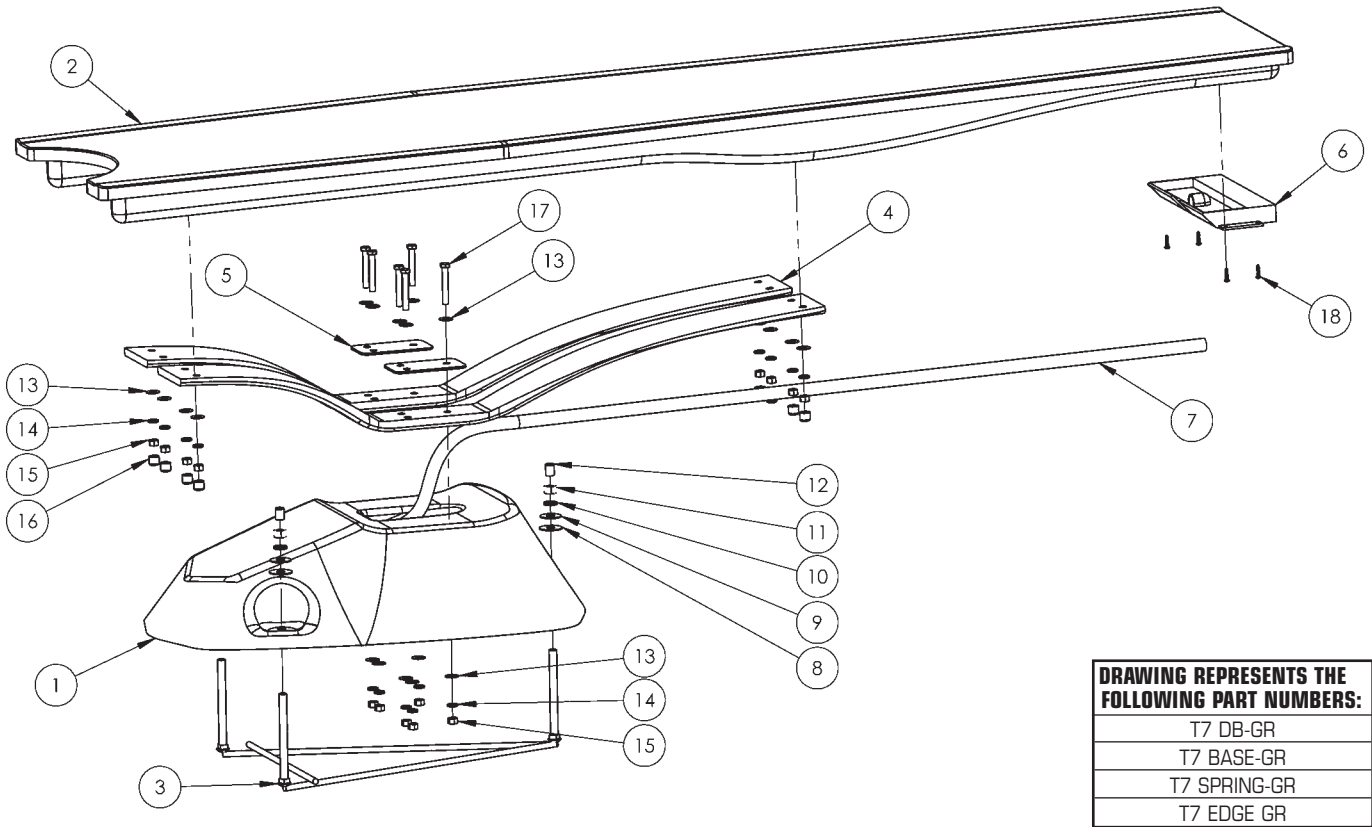

DRAWING REPRESENTS THE FOLLOWING PART NUMBERS:

T7 DB-GR
T7 BASE-GR
T7 SPRING-GR
T7 EDGE GR

TABLE 4 - PARTS LIST

ITEM #	COMPONENT	DESCRIPTION	KITS - QTY. COUNTS			
			T7-NBK	T7-102-SS	EDGE-SP	M/A
1	T7-NBASE-(color code)	NO STEP T7 BASE				1
2	T7-DB-(color code)	7' T7 DIVING BOARD				1
3	T7-NJIG	3 BOLT T7 NO STEP BASE JIG				1
4	T7-NSPRING-(color)	T7 NBASE SPRINGS (pair)				1
5	SPRING PAD (factory installed)	T7 NSPRING PAD				2
6	T7-EDGE-GR (F-GR) / (L-GR)	OPTIONAL EDGEWATER ASSEMBLY				1
7	H-1/2 SPA HOSE	1/2" PVC FLEX SPA HOSE GRAY				1
8	H-1/2 NYLON WAS	1/2" FLAT NYLON WASHER	3			
9	H-SS 1/2 F WAS	1/2" SS FLAT WASHER	3			
10	H-SS 1/2 LOC WA	1/2" SS LOCK WASHER	3			
11	H-SS 1/2 H NUT	1/2" SS HEX NUT	3			
12	H-1-1/2 WHT CAP	.750 X 1-1/2 WHITE UV NUT CAP	3			
13	H-SS 3/8 FLT WA	3/8" SS FLAT WASHER		8	12	
14	H-SS 3/8 LOC WA	3/8" SS LOCK WASHER		8	6	
15	H-SS 3/8 F NUT	3/8" SS FINISH HEX NUT		8	6	
16	H-.562 X .390 CAP	.553 X 1/2" GRAY PROTECTIVE CAP		8		
17	H-SS 3/8 X 2-1/2	3/8" X 2-1/2" HEX HEAD BOLT SS			6	
18	H-SS #8 X 3/4	SS 8 X 3/4" PAN HEAD PHILLIPS SCREW				4

RECOMMENDED TORQUE SCHEDULE FOR ASSEMBLY:

1/2" SS Hardware (T7-NBK Kit)
----> 40-50 FT-LBS

3/8" SS Hardware (T7-102-SS Kit)
----> 20-25 FT-LBS

3/8" SS Hardware (EDGE-SP Kit)
----> 25-30 FT-LBS

HARDWARE NOTE:
Use a small dab of anti seize lubricant (included) on all bolt threads.

NOTES:

* Part #T7 BASE-GR comes WITH jig.

The T7 diving board, base, and springs must be used together and cannot be used separately in any other configuration.